

CITY OF MURRAY CONTROL MONUMENT CARD

DESIGNATION: A6 2010 B
TYPE: 30" POURED CONCRETE MONUMENT W/ CITY DISK
DATE SET: JUNE 2010 QUAD: MURRAY, KY.
HORIZONTAL DATUM: NAD-83 (NSRS 2007)
VERTICAL DATUM: NAVD-88 (GPS) ZONE: KY. S 1602

NORTHING: 1751430.068 FT STATE: KENTUCKY
EASTING: 871375.312 FT COUNTY: CALLOWAY
ELEVATION: 550.38 FT (GPS)
LATITUDE: N 36°36'32.21082" LONGITUDE: W 088°22'13.16979"
SCALE: 1.000024905 CONVERGENCE: -1°35'20.86240"
PLANE AZI. TO AZI. MARK:

To Reach: From the intersection of Hudson Rd. _____
and Culver Rd., go south on Hudson Rd. about 450'
to the station on the left.

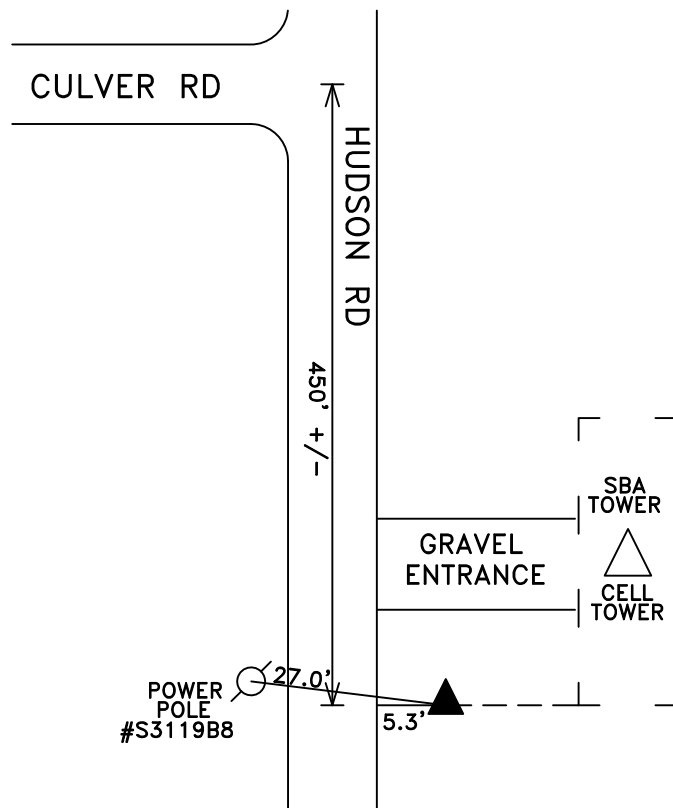

NOT TO SCALE



GRW Aerial Surveys, Inc.
801 Corporate Dr. Lexington Ky. 40503
(859)223-3999